

Mounting accessories for cylinders

Mountings in steel for cylinders ISO 15552



1 - CYLINDERS

Main features

32 ÷ 320 **ISO** FLV..AQIS+V
 Bores Ø **VDMA** Type MF1/MF2

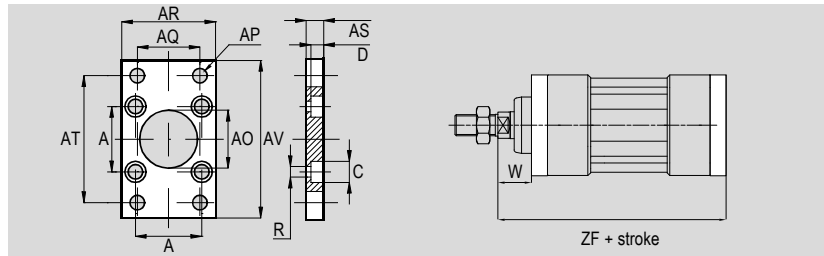

Technical data

Type	Description	Material	Treatment
FLV..AQIS+V	Mounting for cylinders in steel. Flange. For front or rear mounting. Supplied with screws.	Fe 37	White zinc plating

Dimensions

For cylinder Ø mm	Code	Item	A	ØAP	AO	R	AS	AR	AQ	AT	AV	C	D	ZF	W	Weight (g)
32	042119	FLV032AQIS+V	32,5	7	30	6,5	10	45	32	64	86	10,5	5	130	16	-
40	042120	FLV040AQIS+V	38	9	35	6,5	10	52	36	72	96	11	5	145	20	-
50	042121	FLV050AQIS+V	46,5	9	40	9	12	65	45	90	115	15	5,5	155	25	-
63	042122	FLV063AQIS+V	56,5	9	45	9	12	75	50	100	130	15	5,5	170	25	-
80	042123	FLV080AQIS+V	72	12	45	11	16	95	63	126	165	18	7	190	30	-
100	042124	FLV100AQIS+V	89	14	55	11	16	115	75	150	187	18	7	205	35	-
125	042125	FLV125AQIS+V	110	16	60	13	20	140	90	180	224	19	9,5	245	45	-
160	042126	FLV160AQIS+V	140	18	65	17	20	180	115	230	280	25	10,5	280	60	-
200	042127	FLV200AQIS+V	175	22	75	17	25	220	135	270	300	25	12,5	300	70	-
250	042128	FLV250AQIS+V	220	26	90	21	25	270	165	330	390	31	14,5	330	80	-
320	040683	FLV320AQIS+V	270	33	110	25	30	340	200	400	475	37	15	370	90	-

Main features

32 ÷ 320 **ISO** PB..AQIS+V
 Bores Ø **MS1** Type

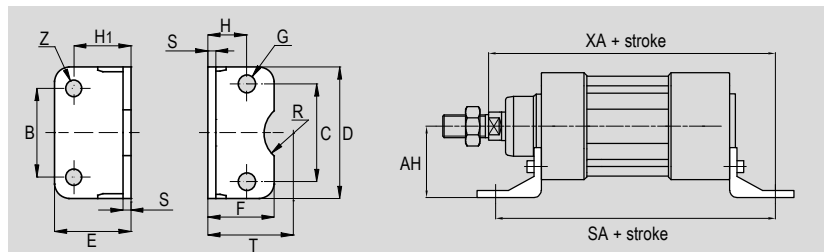

Technical data

Type	Description	Material	Treatment
PB..AQIS+V	Mounting for cylinders in steel. Low foot. For front or rear mounting. Supplied with screws. Supplied individually.	Fe 37	White zinc plating

Dimensions

For cylinder Ø mm	Code	Item	C	B	D	E	F	G	H	H ₁	S	T	R	Z	AH	XA	SA	Weight (g)
32	042129	PB032AQIS+V	32,5	32	45	35	30	7	15,75	24	4	32	15	7	32	144	142	-
40	042130	PB040AQIS+V	38	36	52	36	30	7	17	28	4	36	17,5	10	36	163	161	-
50	042131	PB050AQIS+V	46,5	45	65	47	36	9	21,75	32	5	45	20	10	45	175	170	-
63	042132	PB063AQIS+V	56,5	50	75	45	35	9	21,75	32	5	50	22,5	10	50	190	185	-
80	042133	PB080AQIS+V	72	63	95	55	47	11	27	41	6	63	22,5	12	63	215	210	-
100	042134	PB100AQIS+V	89	75	115	57	53	11	26,5	41	6	71	27,5	14,5	71	230	220	-
125	042135	PB125AQIS+V	110	90	140	65	55	12,5	35	45	8	90	30	16	-	270	250	-
160	042136	PB160AQIS+V	140	115	180	80	75	16,5	45	60	8	115	32,5	18	-	320	300	-
200	042137	PB200AQIS+V	175	135	220	100	90	16,5	47,5	70	9	135	37,5	22	-	345	320	-
250	042138	PB250AQIS+V	220	165	270	110	110	21	55	75	20	165	45	28	-	380	350	-
320	042139	PB320AQIS+V	270	200	350	125	100	24,5	50	85	23	185	50	35	-	425	390	-