

**FINN-POWER**

Crimping since 1973

## SPARE PART LIST

FINN-POWER  
**P20CS**

version 1.5

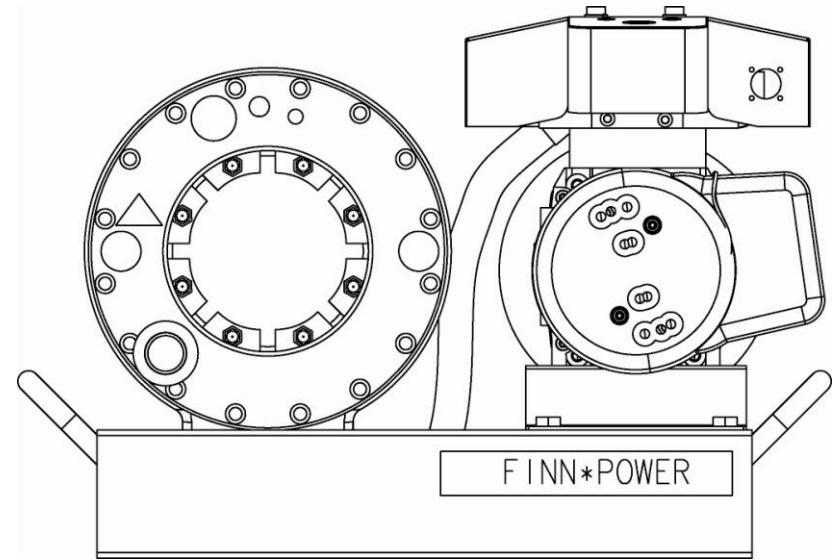

Released 3/2012

706261

# SWAGING HEAD

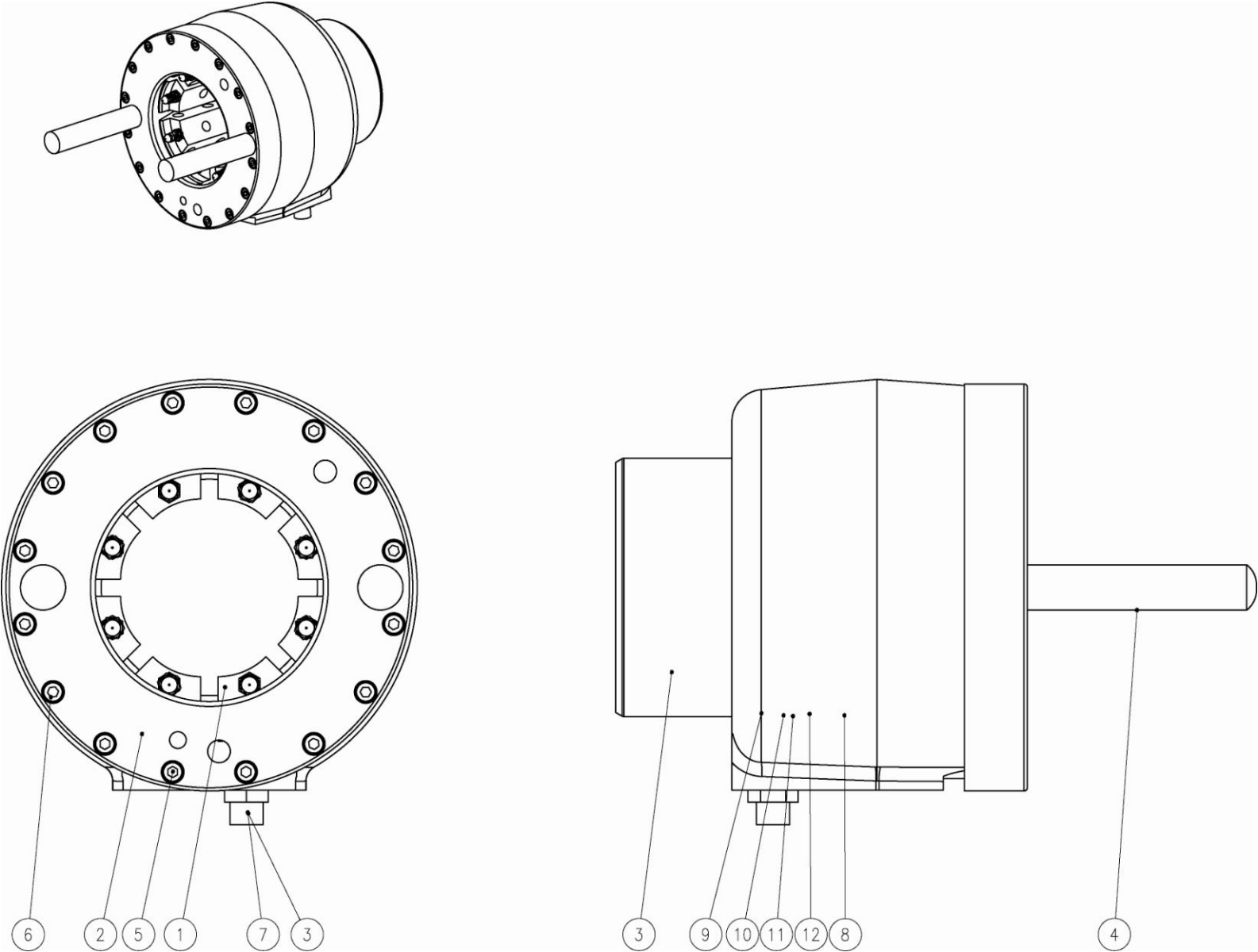

706261

## SWAGING HEAD

F/N	Part Number	Rev	Description	Qty
*1	MD-P20A0	A	ASSEMBLY	1
*2	14331	C	CONIC FLANGE	1
*3	11079	D	PISTON	1
*4	053202	0	GAS SPRING	2
*5	031247	0	HEX SOCKET-HEAD SCREW	2
*6	031244	0	HEX SOCKET-HEAD SCREW	14
*7	042004	0	DOUBLE MALE CONNECTOR	1
*8	706255	0	CYLINDER	1
*9	048102	0	GROOVED RING	1
*10	048201	0	GROOVED RING	1
*11	048301	0	TEFLON RING	1
*12	048301	0	TEFLON RING	1
*13	048403	0	USIT-RING	1

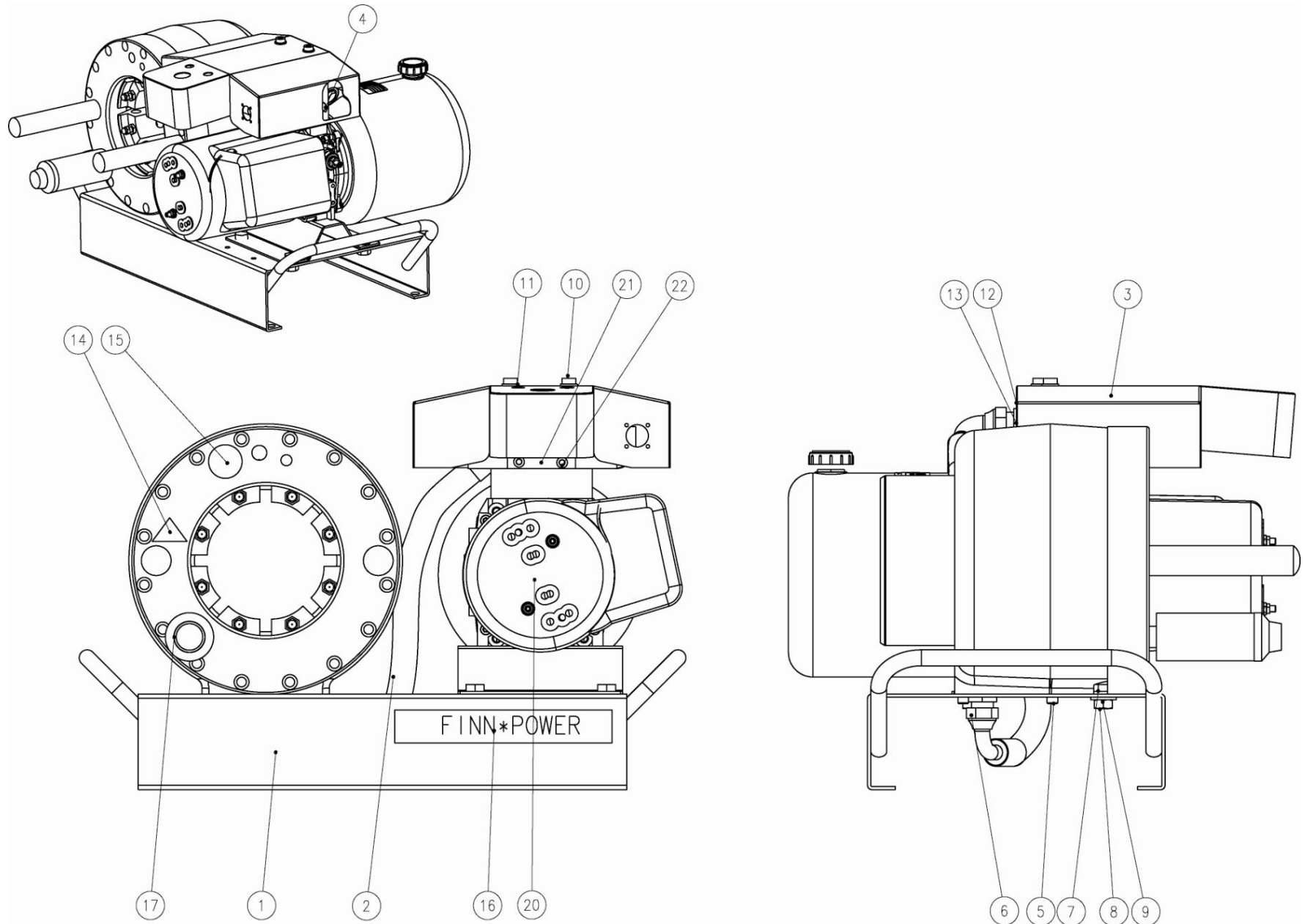

F/N	Part Number	Rev	Description	Qty
*1	16579	I	FRAME	1
*2	706795	0	HOSE ASSEMBLY	1
*3	707432	0	CONSOLE	1
*4	042405	0	TEST TERMINAL	1
*5	031227	0	HEX SOCKET-HEAD SCREW	4
*6	042004	0	DOUBLE MALE CONNECTOR	2
*7	030157	0	HEXAGON SCREW	4
*8	033006	0	HEXAGONAL NUT	4
*9	033306	0	WASHER	4
*10	031331	0	HEX SOCKET-HEAD SCREW	2
*11	033305	0	WASHER	2
*12	043302	0	PLUG	1
*13	048403	0	USIT-RING	1
*14	003306	0	STICKER	1
*15	003199	0	STICKER	1
*16	003226	0	STICKER	1
*17	60424	B	CONTROL DEVICE	1
*18	019302	0	DIE GREASE	1
*19	69154	0	TOOL	1
*20	707394	0	HYDRAULIC UNIT	1
*21	041001/12V	0	DIRECTIONAL VALVE	1
*22	031222	0	HEX SOCKET-HEAD SCREW	4

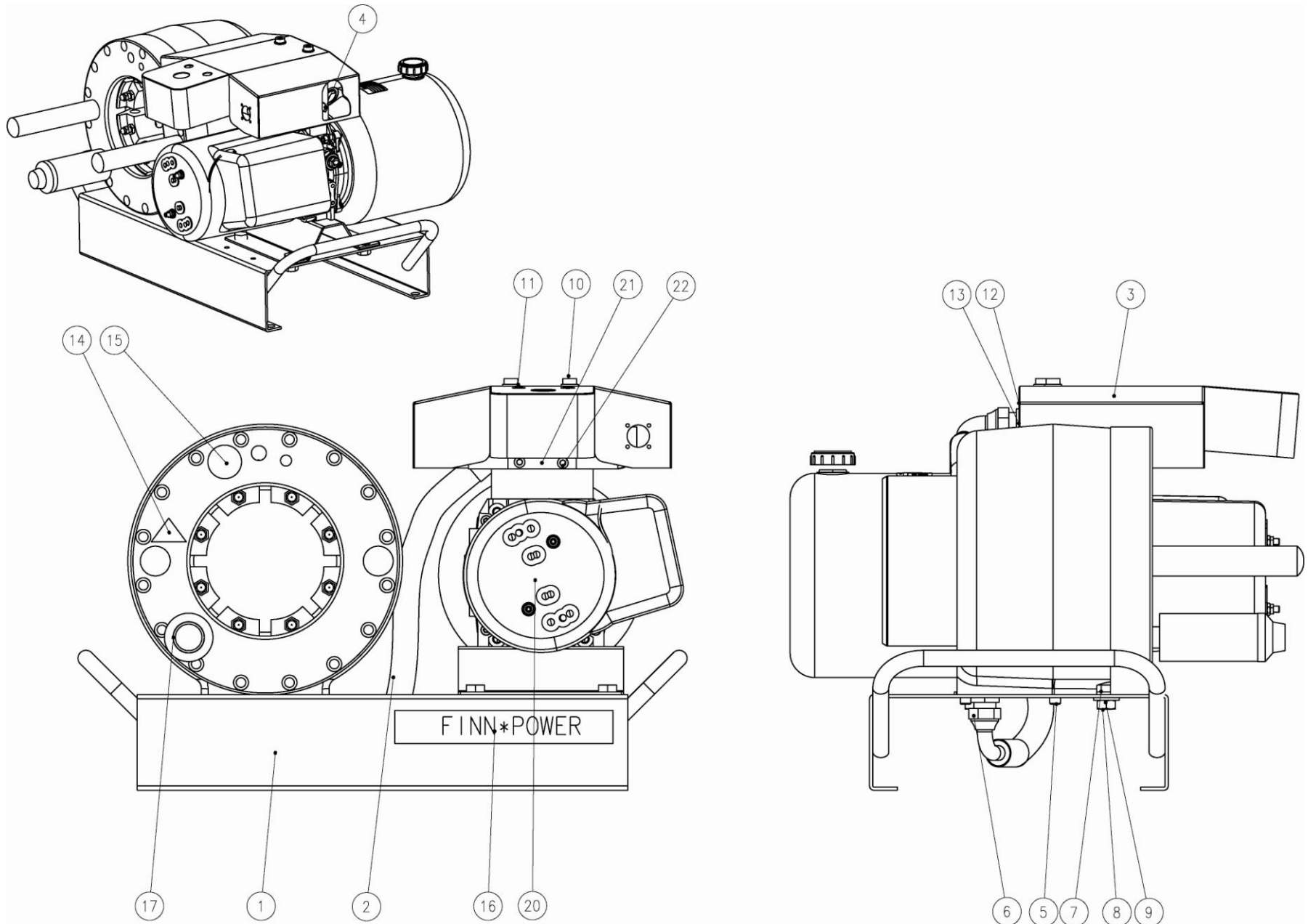

F/N	Part Number	Rev	Description	Qty
*1	16579	I	FRAME	1
*2	706795	0	HOSE ASSEMBLY	1
*3	707432	0	CONSOLE	1
*4	042405	0	TEST TERMINAL	1
*5	031227	0	HEX SOCKET-HEAD SCREW	4
*6	042004	0	DOUBLE MALE CONNECTOR	2
*7	030157	0	HEXAGON SCREW	4
*8	033006	0	HEXAGONAL NUT	4
*9	033306	0	WASHER	4
*10	031331	0	HEX SOCKET-HEAD SCREW	2
*11	033305	0	WASHER	2
*12	043302	0	PLUG	1
*13	048403	0	USIT-RING	1
*14	003306	0	STICKER	1
*15	003199	0	STICKER	1
*16	003226	0	STICKER	1
*17	60424	B	CONTROL DEVICE	1
*18	019302	0	DIE GREASE	1
*19	69154	0	TOOL	1
*20	707395	0	HYDRAULIC UNIT	1
*21	041001	0	DIRECTIONAL VALVE	1
*22	031222	0	HEX SOCKET-HEAD SCREW	4

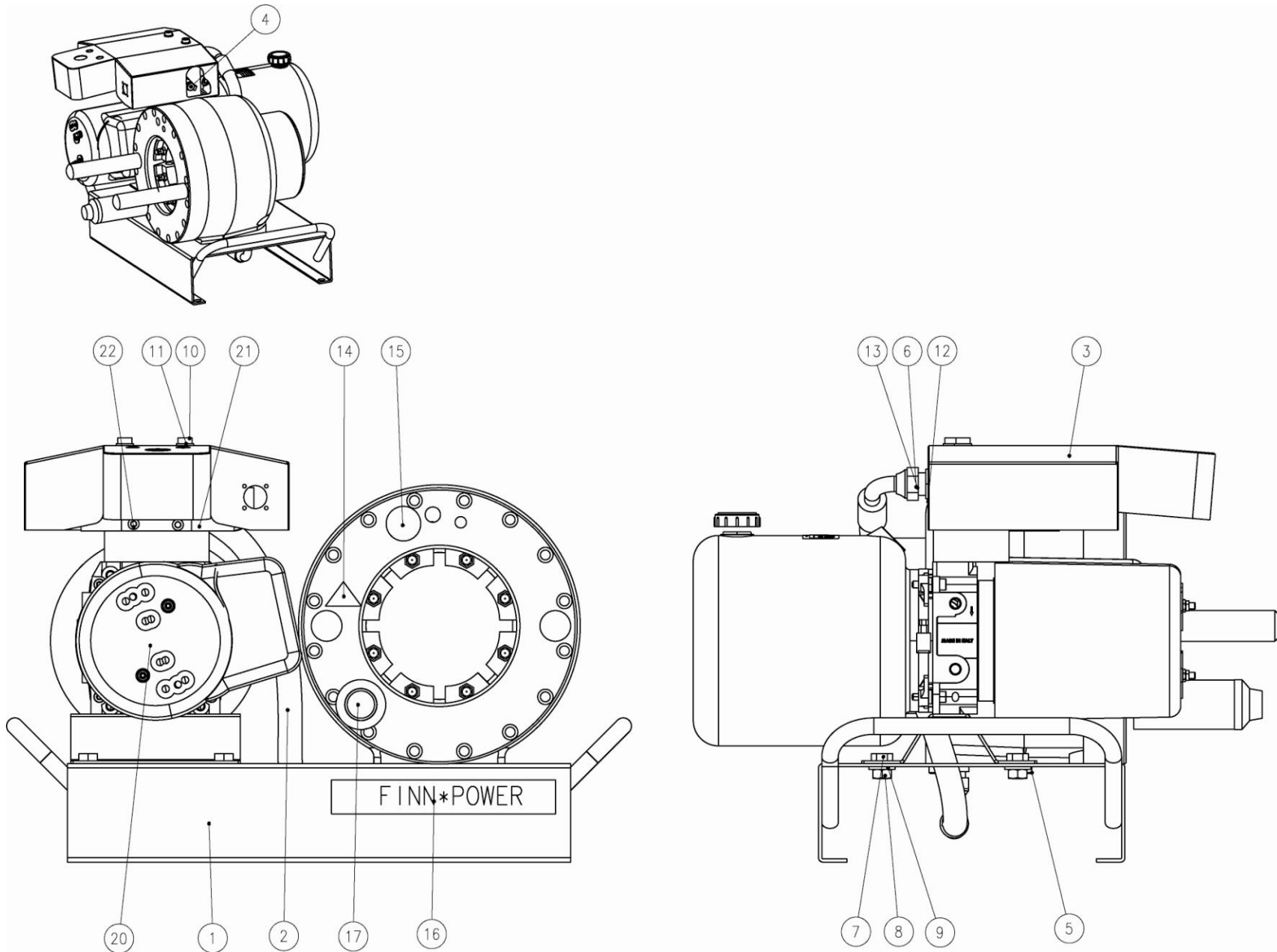



F/N	Part Number	Rev	Description	Qty
*1	16579	I	FRAME	1
*2	56001	B	HOSE ASSEMBLY	1
*3	707432	0	CONSOLE	1
*4	042405	0	TEST TERMINAL	1
*5	031227	0	HEX SOCKET-HEAD SCREW	4
*6	042004	0	DOUBLE MALE CONNECTOR	2
*7	030157	0	HEXAGON SCREW	4
*8	033006	0	HEXAGONAL NUT	4
*9	033306	0	WASHER	4
*10	031331	0	HEX SOCKET-HEAD SCREW	2
*11	033305	0	WASHER	2
*12	043302	0	PLUG	1
*13	048403	0	USIT-RING	1
*14	003306	0	STICKER	1
*15	003199	0	STICKER	1
*16	003226	0	STICKER	1
*17	60424	B	CONTROL DEVICE	1
*18	019302	0	DIE GREASE	1
*19	69154	0	TOOL	1
*20	707394	0	HYDRAULIC UNIT	1
*21	041001/12V	0	DIRECTIONAL VALVE	1
*22	031222	0	HEX SOCKET-HEAD SCREW	4

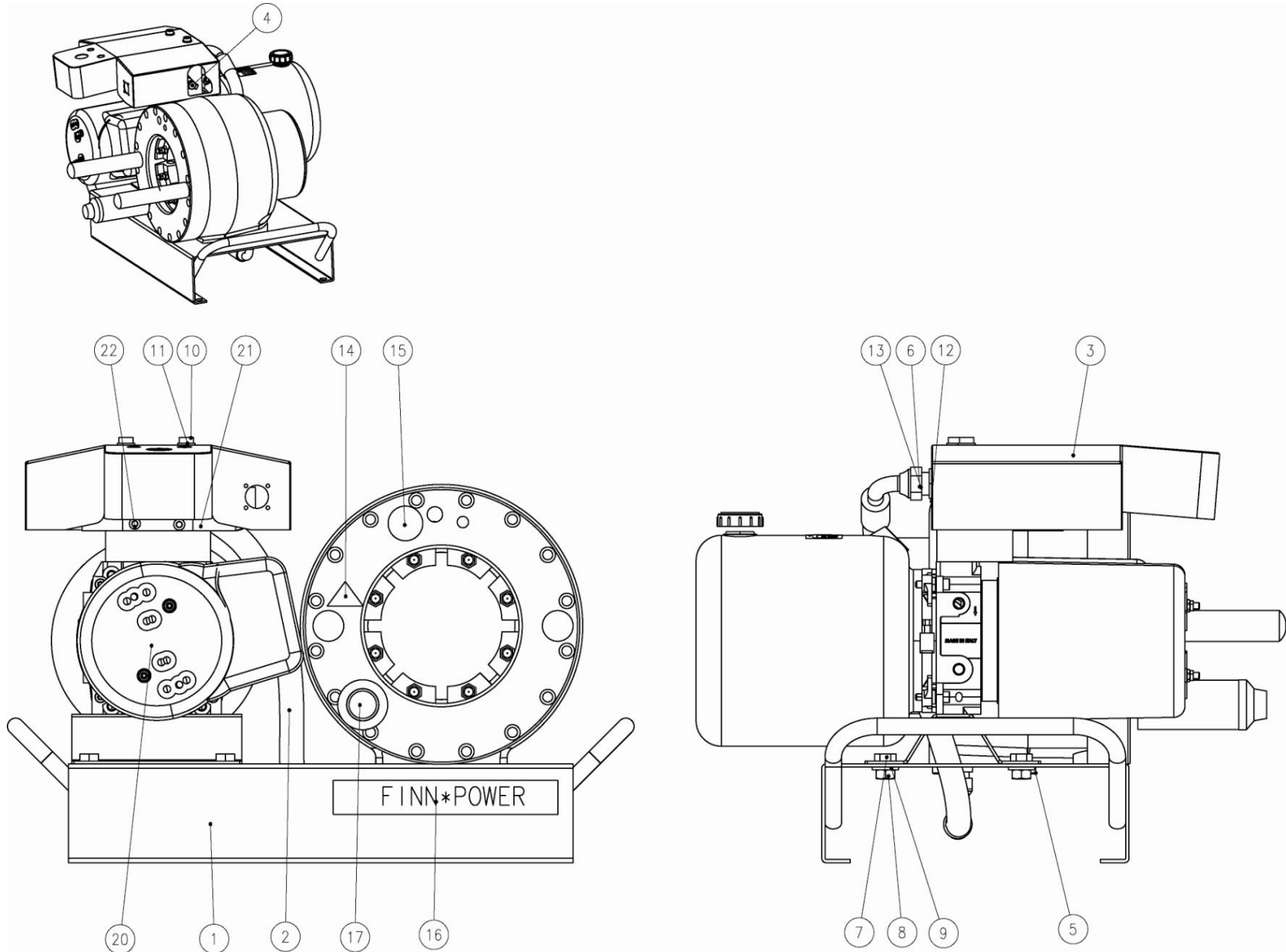

F/N	Part Number	Rev	Description	Qty
*1	16579	I	FRAME	1
*2	56001	B	HOSE ASSEMBLY	1
*3	707432	0	CONSOLE	1
*4	042405	0	TEST TERMINAL	1
*5	031227	0	HEX SOCKET-HEAD SCREW	4
*6	042004	0	DOUBLE MALE CONNECTOR	2
*7	030157	0	HEXAGON SCREW	4
*8	033006	0	HEXAGONAL NUT	4
*9	033306	0	WASHER	4
*10	031331	0	HEX SOCKET-HEAD SCREW	2
*11	033305	0	WASHER	2
*12	043302	0	PLUG	1
*13	048403	0	USIT-RING	1
*14	003306	0	STICKER	1
*15	003199	0	STICKER	1
*16	003226	0	STICKER	1
*17	60424	B	CONTROL DEVICE	1
*18	019302	0	DIE GREASE	1
*19	69154	0	TOOL	1
*20	707395	0	HYDRAULIC UNIT	1
*21	041001	0	DIRECTIONAL VALVE	1
*22	031222	0	HEX SOCKET-HEAD SCREW	4

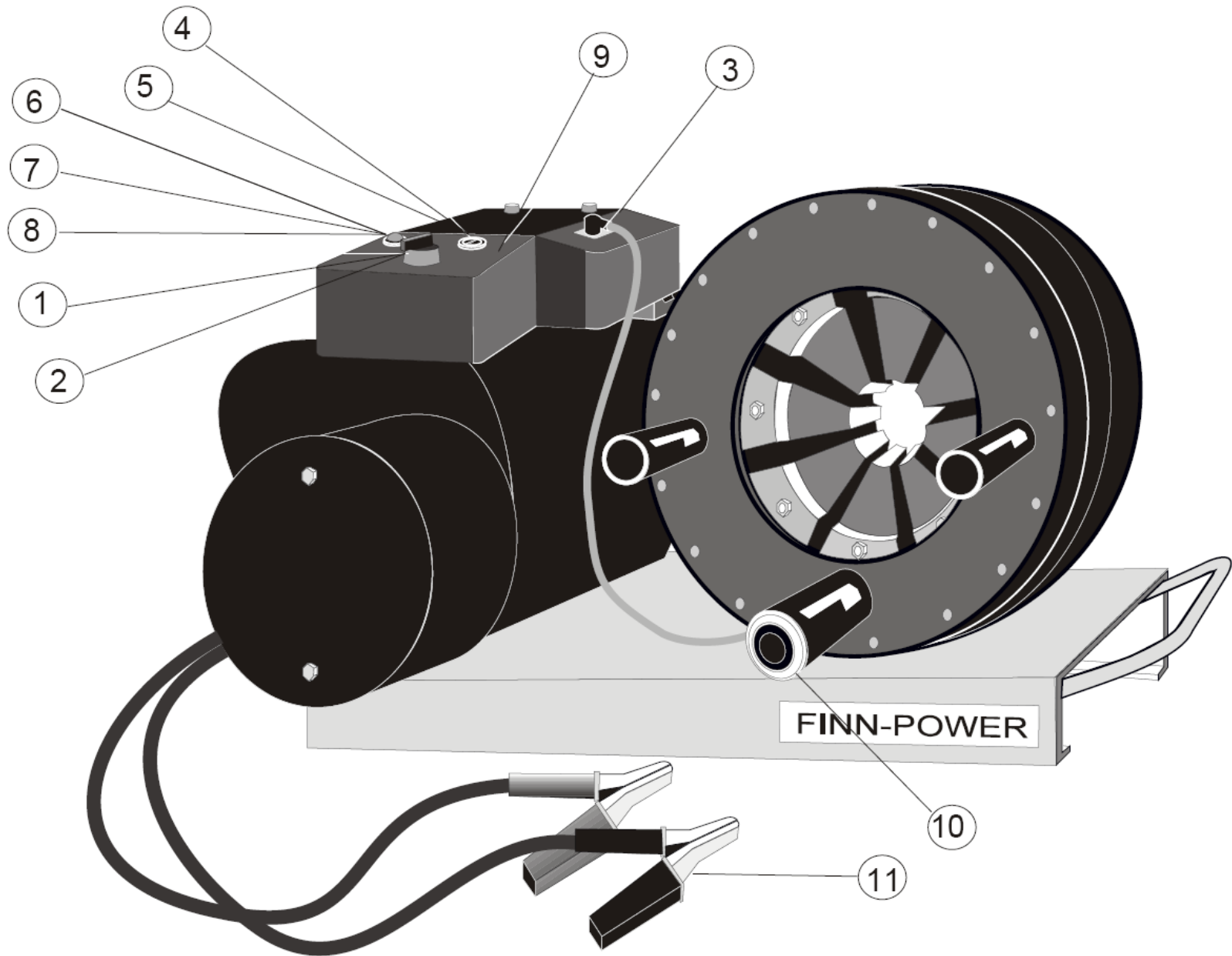

F/N	Part Number	Rev	Description	Qty
*1	092224	0	SWITCH	1
*2	092982	0	CONTACT ELEMENT	1
*3	089305	0	DIN-CONNECTOR	2
*4	086160	0	FUSE BOX	1
*5	086121	0	SAFETY FUSE	1
*6	061017	0	LED	1
*7	061018	0	LED MOUNTING CLIP	1
*8	064053	0	RESISTANCE	1
*9	003557	0	STICKER	1
*10	60424	0	CONTROL DEVICE	1
*11	095080	0	CABLE CLAMP	2

676010

ELECTRICAL EQUIPMENT

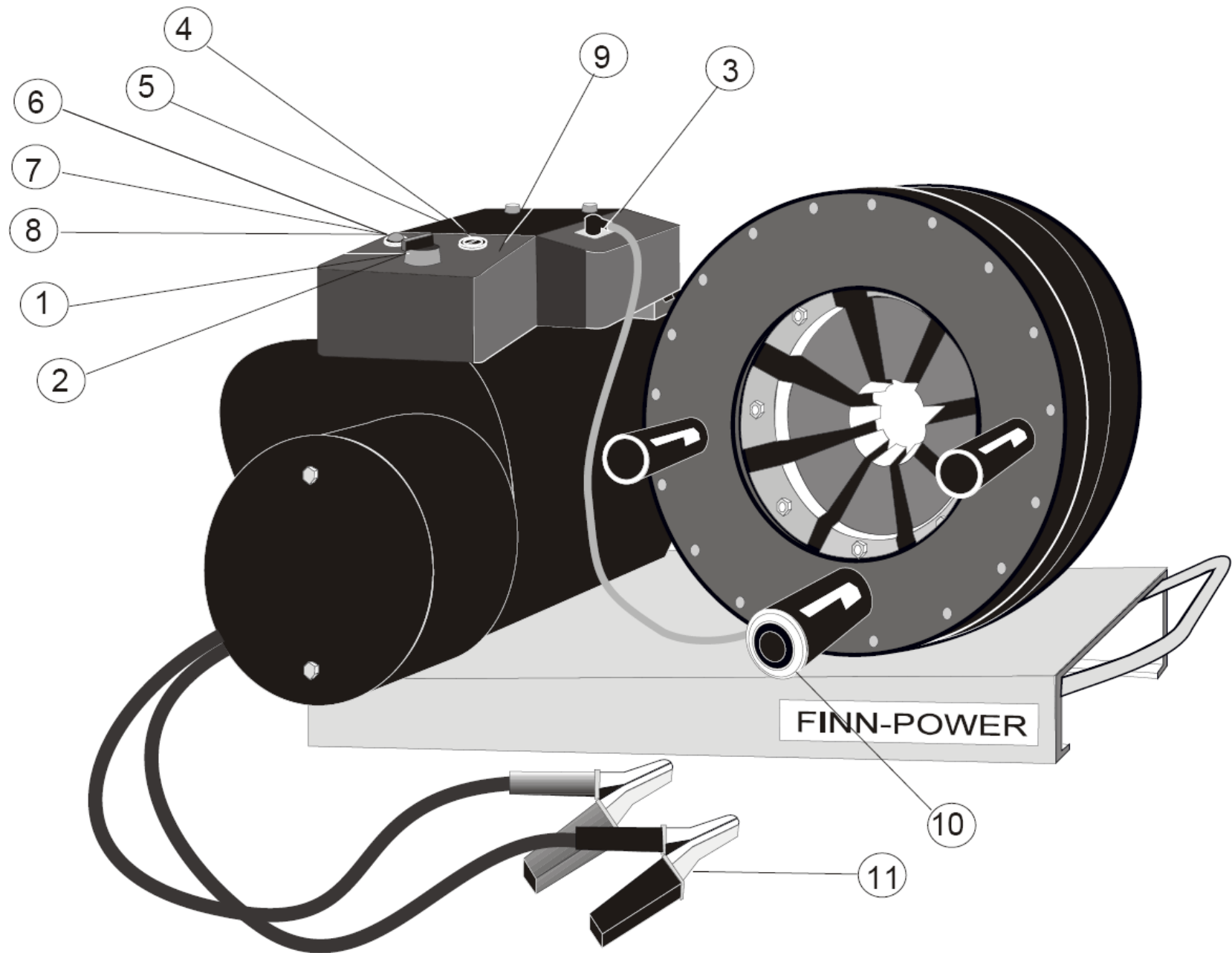

676010

## ELECTRICAL EQUIPMENT

F/N	Part Number	Rev	Description	Qty
*1	092224	0	SWITCH	1
*2	092982	0	CONTACT ELEMENT	1
*3	089305	0	DIN-CONNECTOR	2
*4	086160	0	FUSE BOX	1
*5	086121	0	SAFETY FUSE	1
*6	061017	0	LED	1
*7	061018	0	LED MOUNTING CLIP	1
*8	064053	0	RESISTANCE	1
*9	003557	0	STICKER	1
*10	60424	0	CONTROL DEVICE	1
*11	095080	0	CABLE CLAMP	2

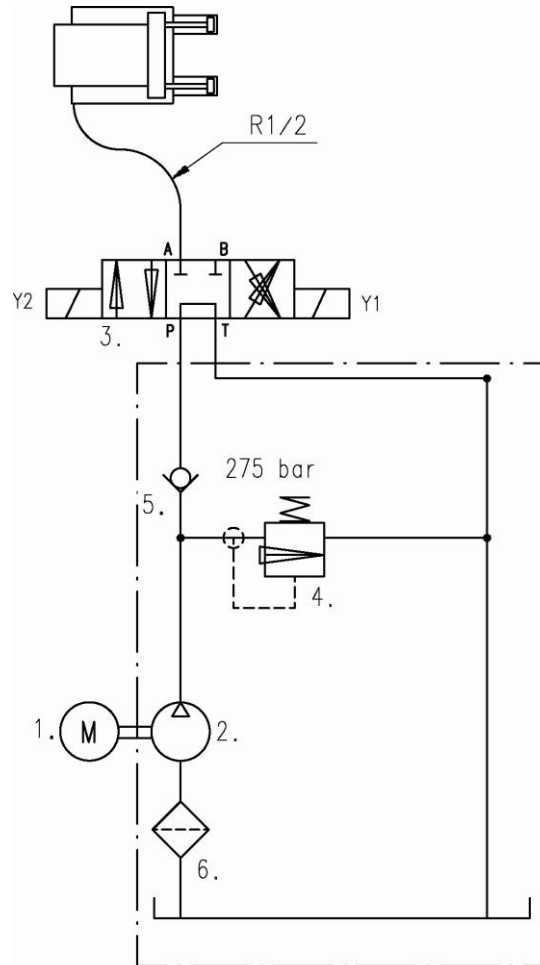

1. Motor 12/24 VDC
2. Pump 1.1 cm<sup>3</sup>/rev
3. Directional valve NG6 12/24VDC
4. Relief valve 275 bar
5. Check valve
6. Filter



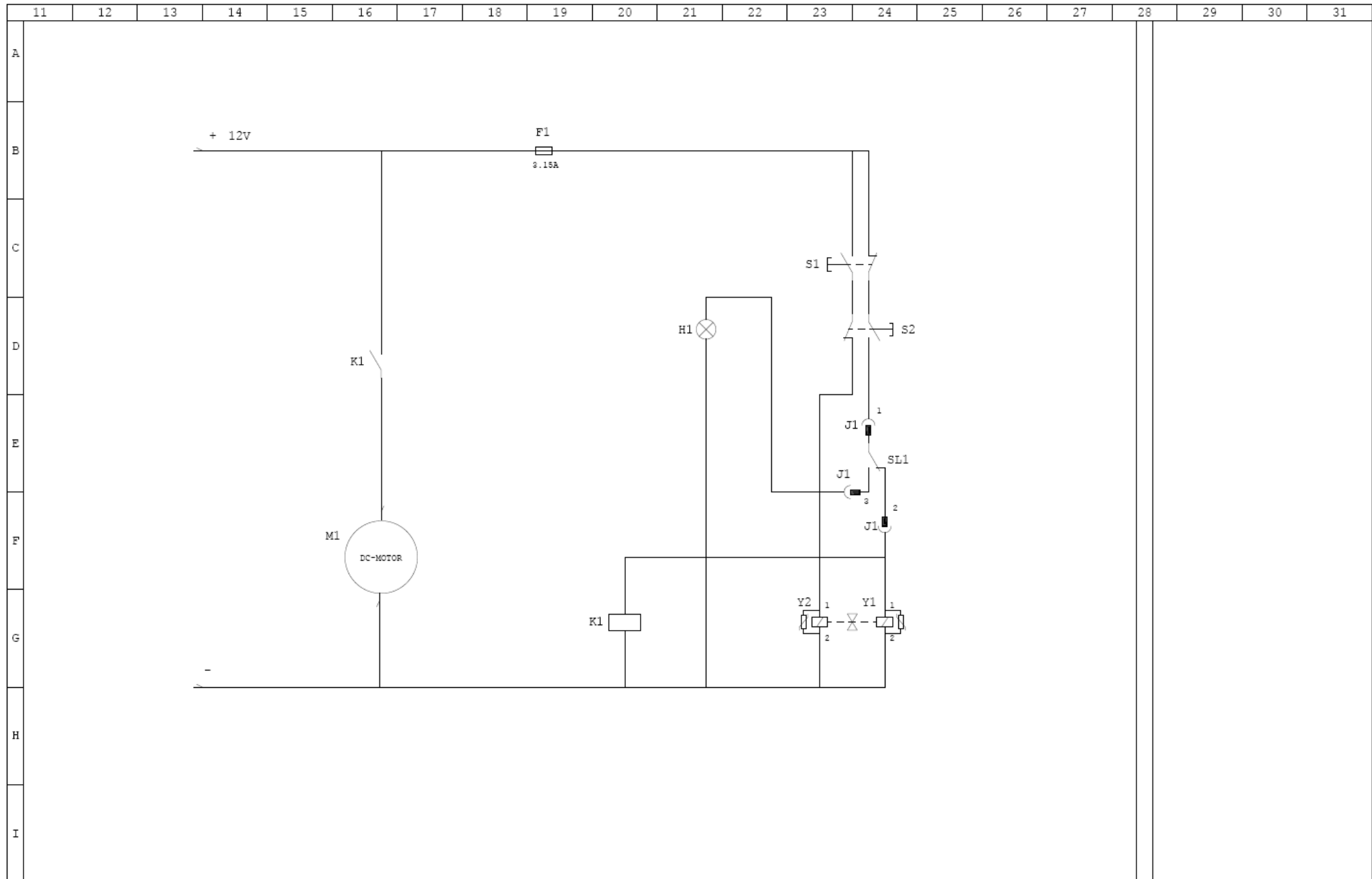

**FINN-POWER**  
**LILLBACKA**

P.O. BOX 38  
62201 KAUHAVA  
TEL: +358 64 4830 111  
FAX: +358 64 4830 228

	date	name		date	name
drawn	1997-09-16	SPe	change		
check			change		
appr			change		

P20/32 CS

ELECTRIC DRAWINGS

WIRING DIAGRAM P20

product	version	control	sheet no
PURISTIN	1.0	M	1 / 2
drawing no			- 572028

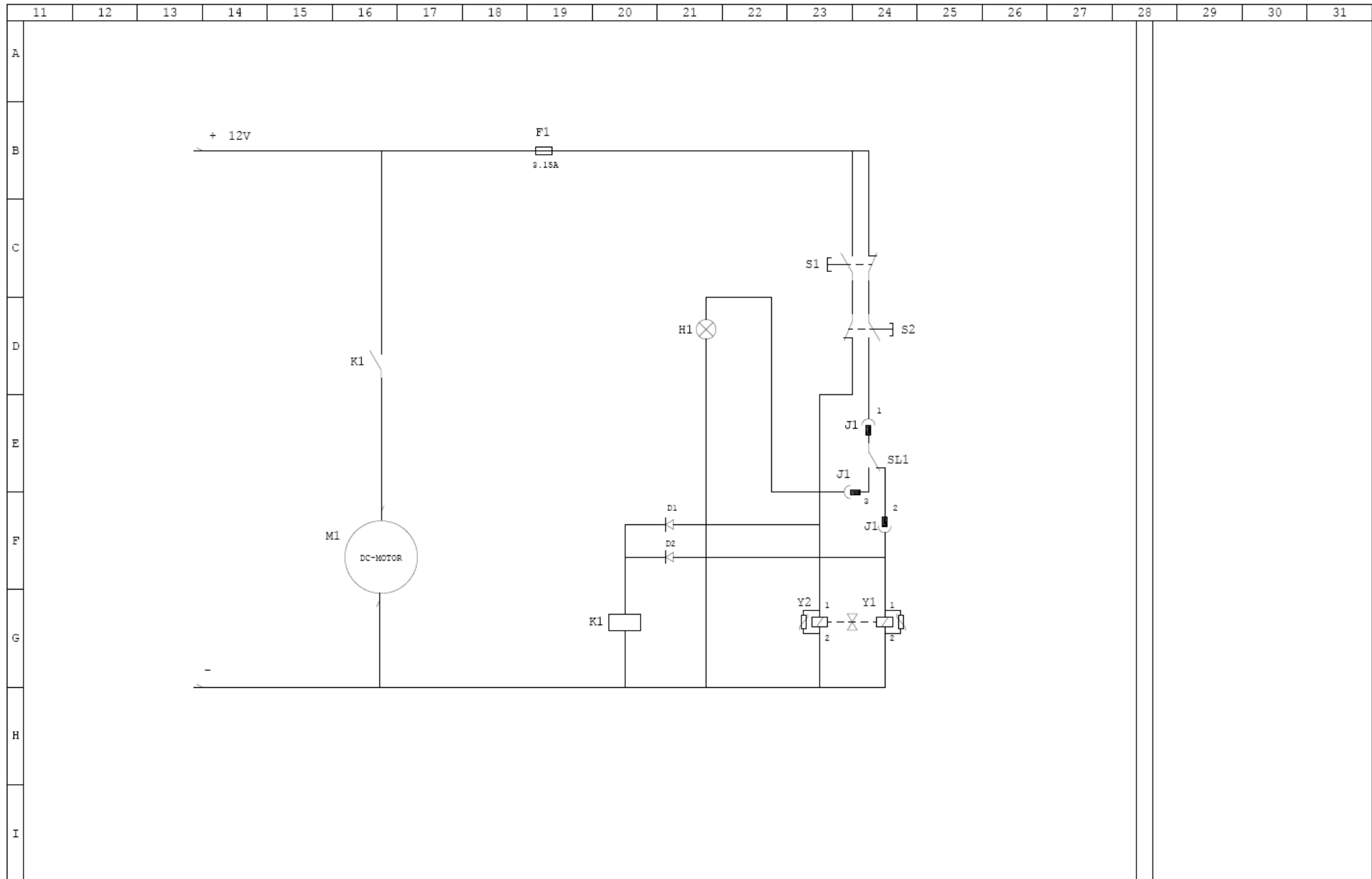

**FINN-POWER**  
LILLBACKA

P.O. BOX 38  
62201 KAUHAVA  
TEL: +358 64 4830 111  
FAX: +358 64 4830 228

	date	name		date	name
drawn	1997-09-14	SPe	change		
check			change		
appr			change		

P20/32 CS

ELECTRIC DRAWINGS

WIRING DIAGRAM P32

product	version	control	sheet no
PURISTIN	1.0	M	2/ 2
drawing no			- 572028