

Solenoid operated valves series A1

1/2", 5/2 Solenoid/Spring



Main features

Version	Code	Item	Symbol
5/2 solenoid/spring	034114	A1E450	
5/2 solenoid/spring with external air pilot	034138	A1K450	



Technical data

Version	5/2 solenoid/spring	5/2 solenoid/spring with external air pilot
Code	034114	034138
Item	A1E450	A1K450
Size	1/2"	
Fluid	Compressed air with or without lubrication. Lubrication, if started, must be continued.	
Pressure range	2,5 ÷ 10 bar	
Minimum external air pressure	-	2,5 bar
Temperature range	-10°C ÷ +60°C (standard)	-25°C ÷ +60°C (BT)
Plunger Ø	9 mm	
Orifice Ø	15 mm	
Flow at 6 bar with ΔP 1 bar	2.900 NI/min.	
Mounting	In every position	
Manual override	Bistable	
Response time at 6 bar	Energizing	60 ms.
	De-energizing	35 ms.

Notes

Coils and connectors for standard versions to be ordered separately.
 For coils type ASA12 and ASA2 see from page 2.315.1. For connectors type A122 e A182 see from page 2.318.1
 For valves complete with ATEX coil and connector, in different classifications, see page 2.320.1

Standard dimensions

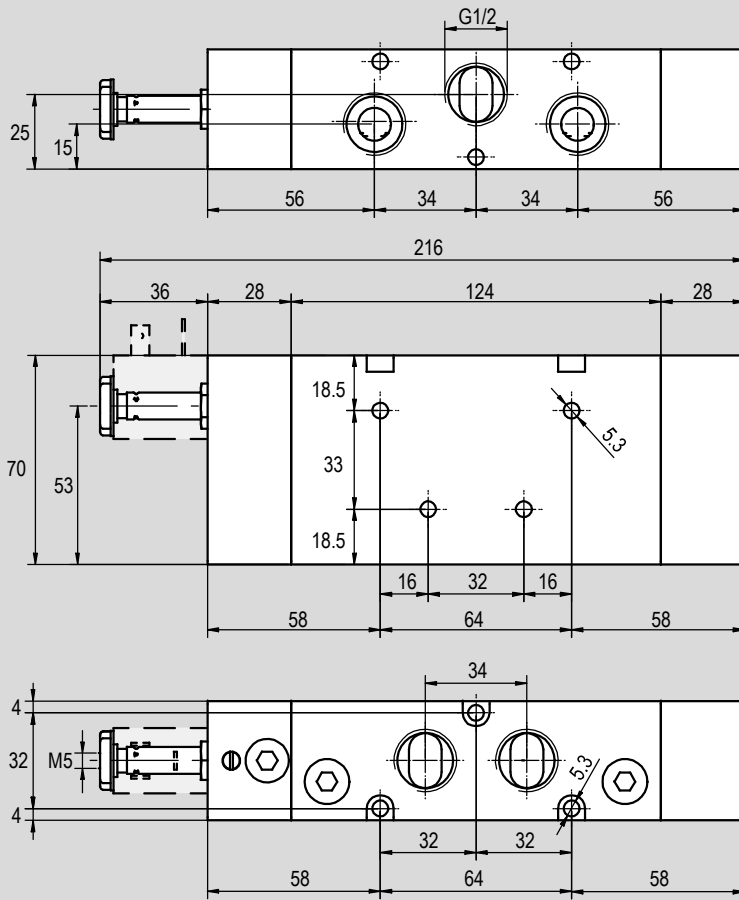

Type: 5/2 solenoid/spring

Type: 5/2 solenoid/spring with external air pilot

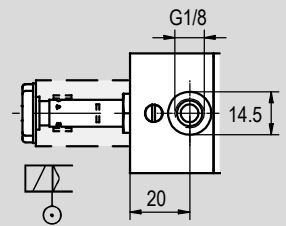

2 - VALVES

Version	Symbol	Code	Item
1/2" 5/2 solenoid/spring		034114	A1E450
1/2" 5/2 solenoid/spring with external air pilot		034138	A1K450